

SECTION-BB
SCALE: 1:100

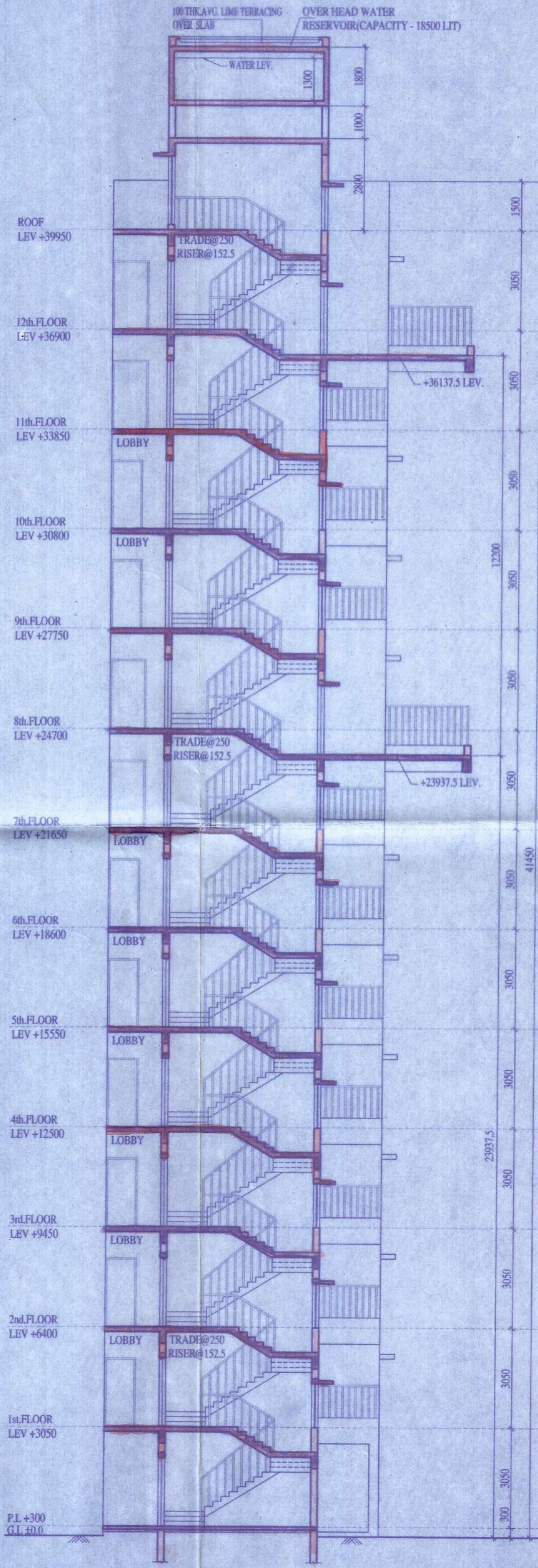

SECTION-CC
SCALE: 1:100

Checked by
[Signature]
Local Officer in-charge
RAJPUR SONARPUR MUNICIPALITY.

- SPECIFICATION**
1. ALL DIMENSIONS ARE IN M.M. UNLESS OTHERWISE SPECIFIED
 2. ALL OUTER WALLS ARE 200 M.M.
 3. ALL PARTITION WALLS ARE 100 M.M. UNLESS OTHERWISE SPECIFIED.
 4. BRICK WORK OF ALL 100 WALLS SHALL BE IN C.M.(1:4) WITH H-R NETTING.
 5. BRICK WORK OF ALL 100 WALLS SHALL BE IN C.M.(1:4) WITH H-R NETTING.
 6. 15 M.M. TH. C. PLASTER WITH C.M. (1:6) FOR OUTER WALLS.
 7. 20 M.M. TH. C. PLASTER WITH C.M. (1:6) FOR INSIDE WALLS.
 8. 10 M.M. TH. C. PLASTER WITH C.M. (1:6) FOR CEILING.
 9. 25 M.M. TH. D.P.C. (1:2-4) SHALL BE PROVIDED.
 10. 10 M.M. TH. VITRIOUS TILES FLOORING.
 11. 150 M.M. WIDE VITRIOUS SKIRTING.
 12. THE DEPTH OF SEWAGE TREATMENT PLANT & WATER RESERVOIR WOULD NOT EXCEED THE DEPTH OF MAIN BUILDING FOUNDATION.
 13. GRADE OF CONCRETE (R.C.C.) M-30
 14. GRADE OF STEEL - Fe-500

Constituted Attorney For
[Signature]
DIRECTOR
STARLITE INFRACON PVT.LTD.

DECLARATION OF E.A.
I HAVE CERTIFIED ON THE PLAN ITSELF WITH FULL RESPONSIBILITY THAT BUILDING RULES NOT AS AMENDED FROM TIME TO TIME AND THAT THE SITE CONDITIONS INCLUDING THE ADJUTING ROAD CONFORM WITH THE PLAN AND THAT IT IS A BUILDABLE SITE AND NOT A TANK OR A FILLED UP LAND.
[Signature]
MUKUL MITTRA
B. ARCH (HONS) FIA, AIV
REGISTERED ARCHITECT
REG. NO - CA/75/003

656/RJPSON/EBA/2008-09
SIGNATURE OF ARCHITECT
MUKUL MITTRA
B. ARCH (HONS), FIA, AIV
EMPANELMENT NO. 856/RJPSON/EBA/2008-09

CERTIFICATE OF STRUCTURAL STABILITY
I HEREBY DECLARE THAT THE FOUNDATION AND SUPER-STRUCTURE OF THE BUILDING PROPOSED FOR CONSTRUCTION ON R.S. DIAG NO-3102,3103,3139, LR 3140,3141,3220,3143,3142, RS 3106,3168 & 3105 KHATIAN NO- RS 666,684/2,468,712,573,83,60,643,674, 1367,1642,411,3115/1 & 1648 J.L. NO- 71, MOUZA - JAGADDAL, WARD NO- 25, HOLDING NO- 11 UNDER RAJPUR SONARPUR MUNICIPALITY, HARINAVI, KOLKATA - 700 148 HAVE BEEN SO DESIGNED BY ME THAT IT WILL MAKE SUCH FOUNDATION AND SUPER-STRUCTURE SAFE IN ALL RESPECT INCLUDING THE CONSIDERATION OF BEARING CAPACITY OF SOIL ETC.
[Signature]
BIBEK BIKASH MULLICK
Rajpur Sonarpur Municipality
E.S.E. 021

SIGNATURE OF STRUCTURAL ENGINEER
BIBEK BIKASH MULLICK
B.E. (CIVIL)
EMPANELMENT NO. - BSE-021

[Signature]
KAUSHIK SENGUPTA
B.E. (CIVIL), M.E. (STRUCTURE)
EMPANELMENT NO. - ESE-006

SIGNATURE OF STRUCTURAL REVIEWER
KAUSHIK SENGUPTA
B.E. (CIVIL), M.E. (STRUCTURE)
EMPANELMENT NO. - BSE-039

[Signature]
ALOK ROY
Enlisted Geotechnical Engineer
Rajpur - Sonarpur Municipality
No. - 008, G.T. Eng.

SIGNATURE OF GEO-TECHNICAL ENGINEER
ALOK ROY
B.E. (CIVIL), M.C.E. (FOUNDATION ENGG.)
EMPANELMENT NO. - GT/008

PROJECT TITLE
PROPOSED G+XII, G+V(2 NOS), G+IV STORED RESIDENTIAL BUILDING AT R.S. DAG NO - 3102, 3103, 3139, LR3140, 3141, 3220, 3143, 3142, RS 3106, 3168 & 3105 KHATIAN NO- RS 666,684/2,468, LR 712,573,83,60, 643,674,1367,1642,411,3115/1 & 1648 J.L. NO- 71, MOUZA - JAGADDAL, WARD NO- 25, HOLDING NO- 11, DR. B.C. ROY ROAD UNDER RAJPUR SONARPUR MUNICIPALITY, HARINAVI, KOLKATA - 700 148
PREV. SANC. NO. : 1297/CB/25/21 DATED - 13/01/2014

NAME OF OWNER = M/S STARLITE INFRACON PVT LTD & OTHERS
TITLE :
BLOCK - D (G+XII)

SECTION - BB, & SECTION - CC

PROJECT ARCHITECT :-
CONSULTANTS FOR HUMAN SETTLEMENT
FLAT-30, 7TH Floor, 105 Park Street, Kolkata-700016
Tel: +91-33-22651263/64, E-mail : saugata.shel@rediffmail.com
164/B Becharam Chatterjee Street, Kolkata-700061 566 Anna Salai, Teyyanpet, Chennai- 600018

DEALT BY: INDRANI
SCALE : 1:100
DATE : 06.09.2018
DRG. NO. : DNP/ARCH/SUB/BLOCK - D/04

OFFICE USE ONLY
APPROVED
Plan No. *152/ke/2018/44*, Dated. *19/11/2018*
Valid Up to *19/11/2023*
[Signature]
Mukul Kumar Das
Assistant Engineer in-charge P.W.D.
RAJPUR-SONARPUR MUNICIPALITY
[Signature]
Dr. Palab Das
Chairman
RAJPUR-SONARPUR MUNICIPALITY

